



Baglietto Dom 115

34.20 M > 2026 > ITALY

Baglietto Dom 115

LOA:
34.20 m

YEAR:
2026

ASKING PRICE:
€ 17,500,000
EXCL. VAT

YACHTS FOR SALE

> ABOUT

The DOM115 is the 35-m entry-level in the successful DOM series, with exteriors once more designed by Stefano Vafiadis.

The DOM115 retains the stylistic features that made the success of the top model in her series – timeless and yet modern, captivating lines that take to extremes the sporty character of her larger sister ship; impressive volumes, quite unique on a vessel of this size; and large, panoramic windows which let in plenty of natural light and open up onto beautiful terraces.

This model takes the concept of one single, harmonious open space to the next level: the doors of the main deck saloon can be opened completely and concealed to seamlessly connect the interiors and exteriors and, combine with the huge floor-to ceiling windows, offer a breathtaking 270-degree view.

The upper deck, too, is entirely glazed and opens up on three sides. Space has been radically rearranged finding innovative solutions, more consistent with the lifestyle of a contemporary owner seeking a closer contact with nature and the sea.

KEY FEATURES:

- Large swimming pool on the stern
- Delivery in 2026
- Official guarantee
- Italian design

The company is not responsible for the accuracy of the information provided by the Owner (images, yacht specification, list of installed equipment, its status, engine hours, legal issues). The engine hours are indicated at the time of placing information about the vessel on the site and are periodically updated in the future. Exact parameters and characteristics can be provided at the request of the buyer and are specified in the sales contract. All information provided regarding prices, condition, technical characteristics and / or the possibility of operating yachts on the water is for informational purposes and is not a public offer.

Baglietto Dom 115

LOA:
34.20 m

YEAR:
2026

ASKING PRICE:
€ 17,500,000
EXCL. VAT

YACHTS FOR SALE

> SPECIFICATIONS

Type	Displacement motor yacht	Deck	Teak
Delivery	2026	Engines	2 x Caterpillar C18 800 HP
Location	Italy	Max. Speed	14.5 kn
LOA	34.50 m	Cruising speed	13.5 kn
Beam	7.80 m	Fuel tank	24 000 l
Draft	2.40 m	Water tank	5 000 l
Displacement	200 t	Range	3 500 nm at 10 kn
GT	298 GT	Guests	10 persons
Naval architecture	BAGLIETTO	Crew	7 persons
Interior	STEFANO VAFIADIS DESIGN	Guest accommodation	5 cabins: 1 x Double bed MASTER SUIT, 2 x Double bed VIP SUITS, 2 x Twin bedrooms with extra bed
Exterior	STEFANO VAFIADIS DESIGN	Crew accommodation	4 cabins: 1 x captain cabin, 3 x twin bed crew cabins
Hull	Steel		
Superstructure	Aluminium/Steel		

The company is not responsible for the accuracy of the information provided by the Owner (images, yacht specification, list of installed equipment, its status, engine hours, legal issues). The engine hours are indicated at the time of placing information about the vessel on the site and are periodically updated in the future. Exact parameters and characteristics can be provided at the request of the buyer and are specified in the sales contract. All information provided regarding prices, condition, technical characteristics and / or the possibility of operating yachts on the water is for informational purposes and is not a public offer.









SUNDECK



FORDECK

BEACH CLUB



AFT DECK



INTERIOR



INTERIOR



INTERIOR

> GENERAL ARRANGEMENT

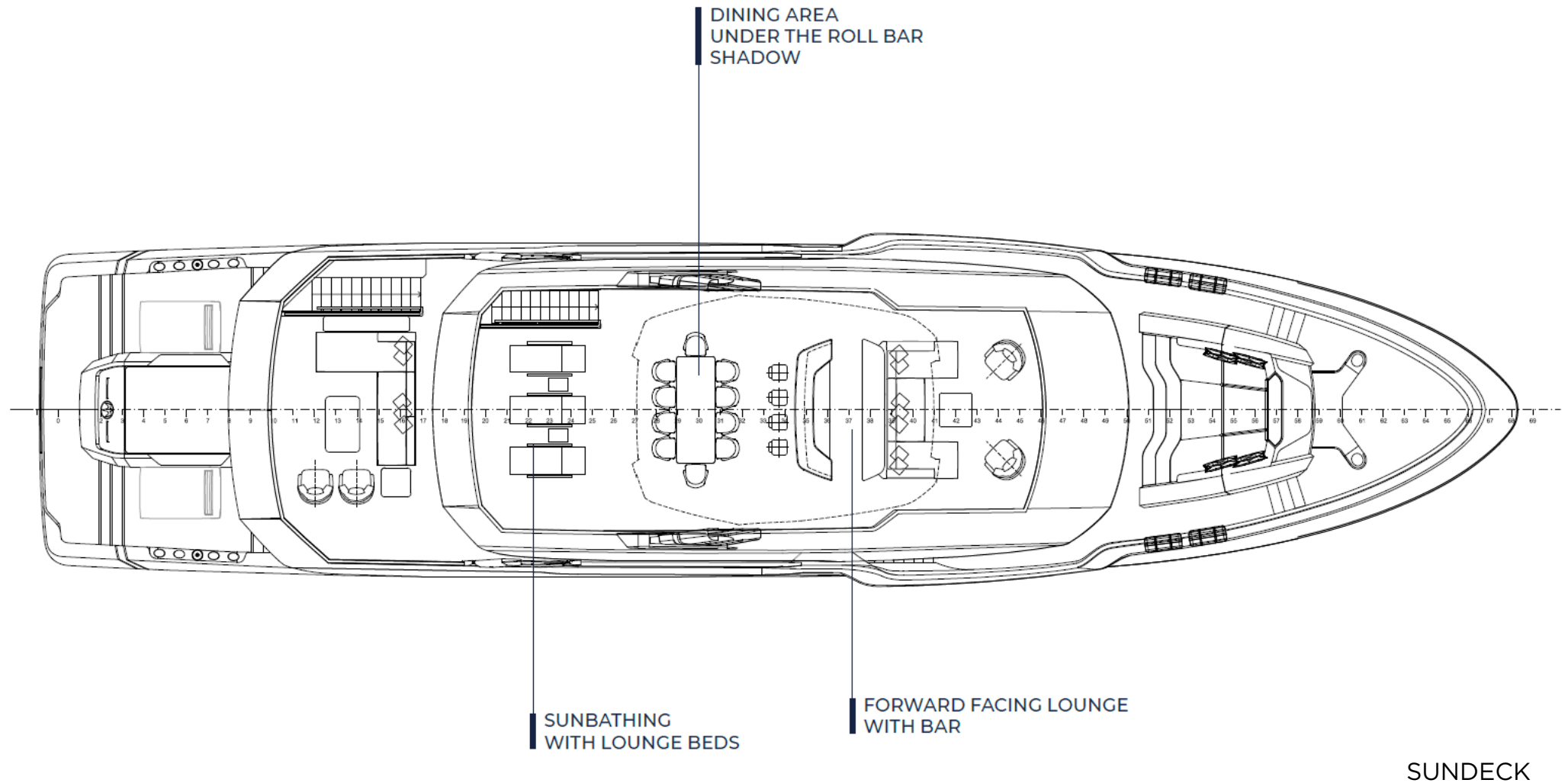

> GENERAL ARRANGEMENT

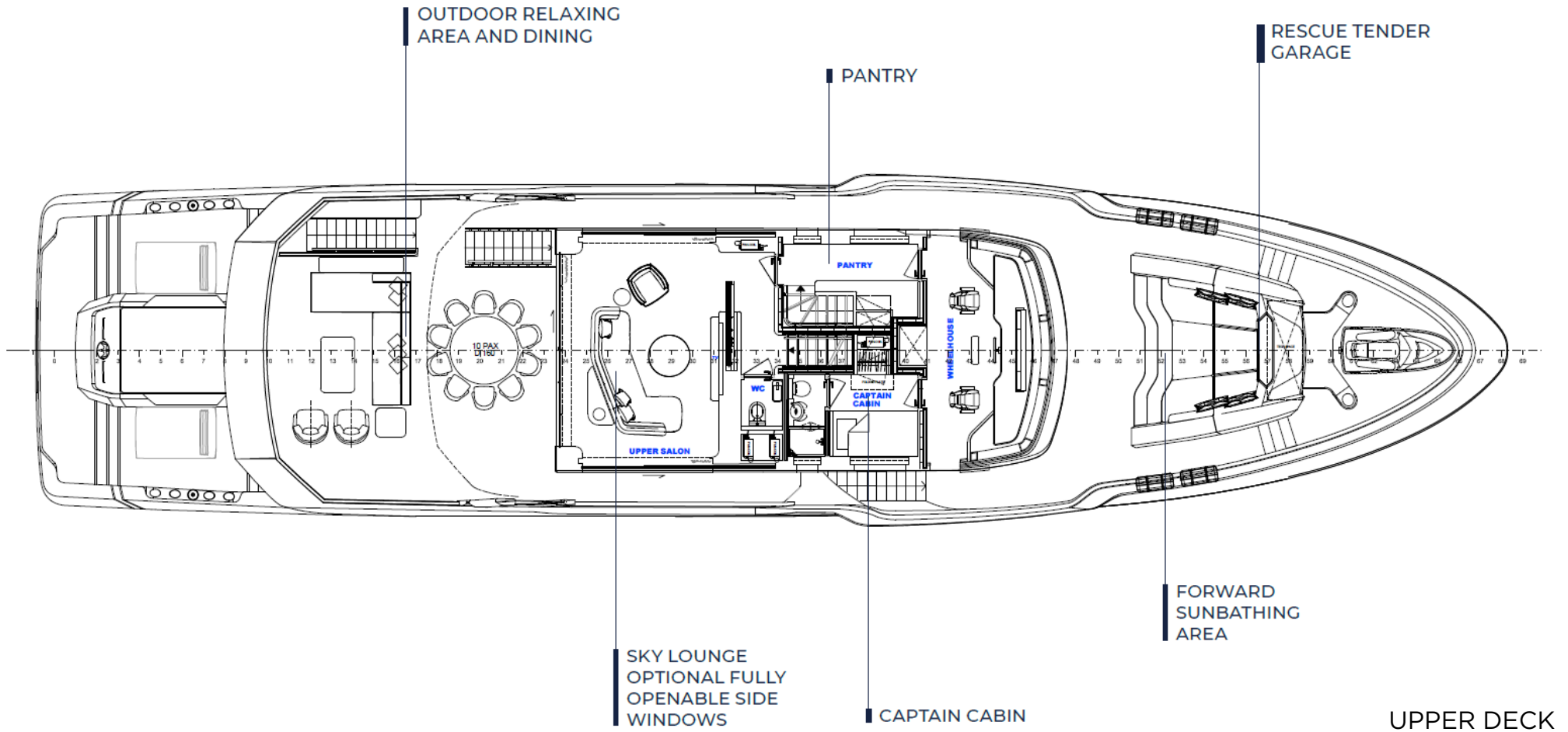

> GENERAL ARRANGEMENT

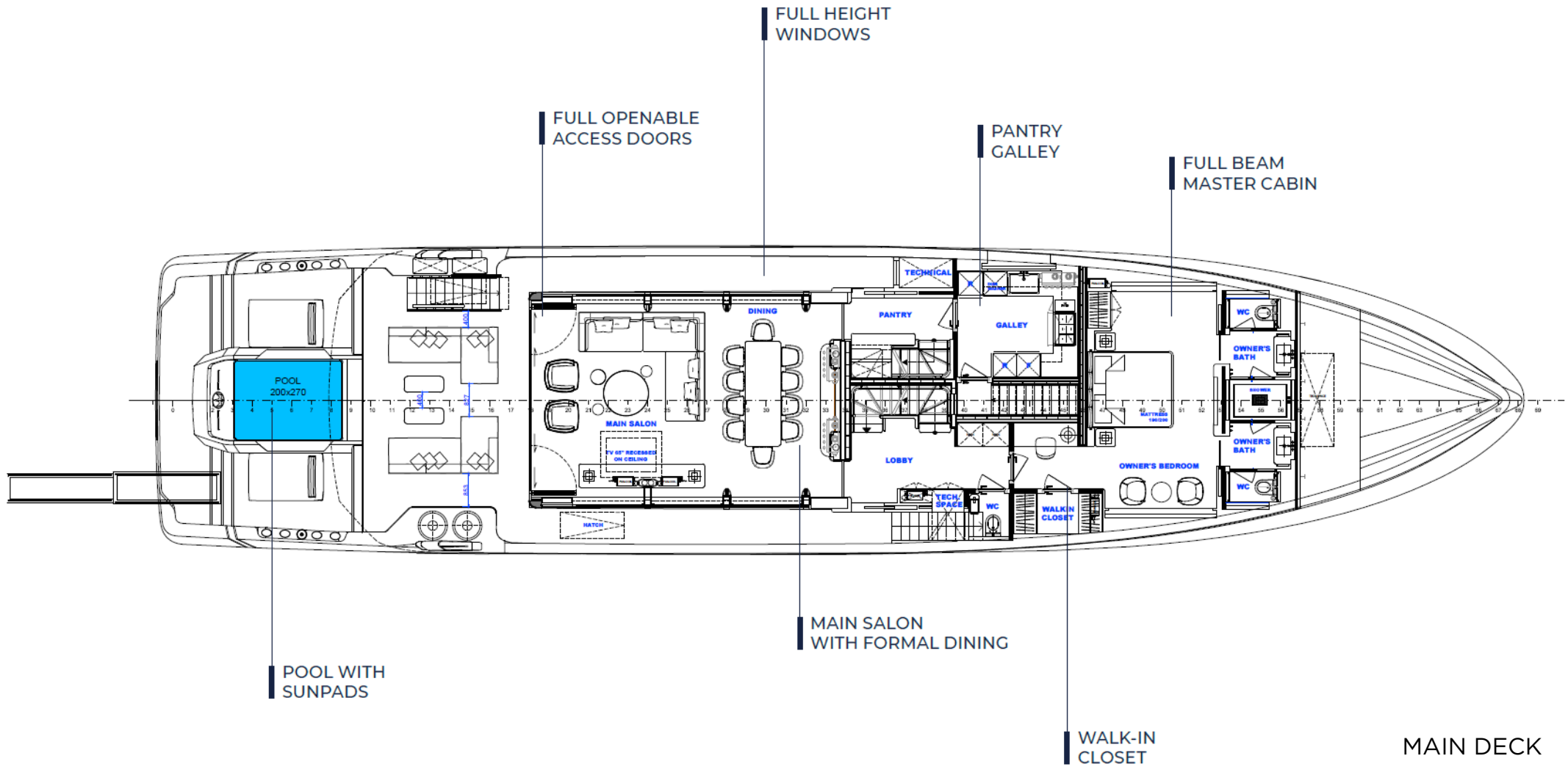



› CONTACT INFORMATION

Nord Star Superyachts specializes in yacht sales, construction, management and consulting. We provide a full range of services for yacht owner support: legal assistance, technical survey, shipping, yacht registration, insurance and crew selection.



DENIS KHAMZATOV

Head of Sales

+371 25 630 696

dk@nordstarsuperyachts.com

NORD STAR SUPERYACHTS

Marventas d.o.o.

Tržaška cesta 2,

Ljubljana, 1000 Slovenia

+386 6 818 04 88

info@nordstarsuperyachts.com

www.nordstarsuperyachts.com