



## Bilgin 163 (50M)

49.95 M > 2024 > TURKEY

# Bilgin 163 (50M)

LOA:  
**49.95 m**

YEAR:  
**2024**

ASKING PRICE:  
**Price on  
request**

YACHTS FOR SALE

## > ABOUT

Bilgin Yachts' CEO İsmail Şengün describes the new 163 series as one of Bilgin's most ambitious projects and a perfect example of what we can offer to our clients. With exterior design and naval architecture by Unique Yacht Design and interior design by Hot Lab, the 50-meter Bilgin 163 series is as trendy and comfortable as her predecessors Snow 5 and Starburst III. The brand-new project has 20 percent larger areas compared to 48m yachts which makes her even more special. The second hull of the Bilgin 163 series -built on-spec- will be delivered in April 2024.

With a six-cabin layout, Bilgin 163 has a great harmony in the living areas thanks to her natural colors, large windows and high-gloss materials. With a 21-meter long sundeck and 12-meter long bridge-deck aft, she also offers the largest exterior spaces among her contemporaries. Berkay Yılmaz, the Commercial Director of Bilgin Yachts describes the interior of Bilgin 163- II as modern, luxurious and elegant. He says, "The yacht has very generous head heights throughout the living areas, large windows and low bulwark lines that increase the visibility in the main living room." He underlines the fact that the yacht has an abundant natural light which is a great source of warmth, comfort and health. He continues his words as follows: "A Fullheight round glass wall separates the lobby from the main living room. Hot Lab team has added special features such as a floating staircase, skylight at sundeck floor and an amazing chandelier in the main lobby."

## KEY FEATURES:

- Hull: Steel
- Delivery in 2024
- Official guarantee

# Bilgin 163 (50M)

YACHTS FOR SALE

LOA:  
**49.95 m**

YEAR:  
**2024**

ASKING PRICE:  
**Price on  
request**

## > SPECIFICATIONS

Type	Displacement	Deck	Teak
Delivery	2024	Engines	2 x CAT C32 1081 kW
Location	Turkey	Max. Speed	17 kn
LOA	49.95 m	Cruising speed	12 kn
Beam	9.25 m	Fuel tank	55 000 l
Draft	2.60 m	Water tank	11 000 l
Displacement	495 t	Range	5000 n/M
GT	499 GT	Guests	12 persons
Naval architecture	Unique Yacht Design	Crew	8+1 persons
Interior	Hot Lab Yacht Design	Guest accommodation	6 cabins
Exterior	Unique Yacht Design	Crew accommodation	5 cabins
Hull	Steel	-	-
Superstructure	Aluminium		

The company is not responsible for the accuracy of the information provided by the Owner (images, yacht specification, list of installed equipment, its status, engine hours, legal issues). The engine hours are indicated at the time of placing information about the vessel on the site and are periodically updated in the future. Exact parameters and characteristics can be provided at the request of the buyer and are specified in the sales contract. All information provided regarding prices, condition, technical characteristics and / or the possibility of operating yachts on the water is for informational purposes and is not a public offer.











SALON





SALON



MASTER CABIN

> GENERAL ARRANGEMENT

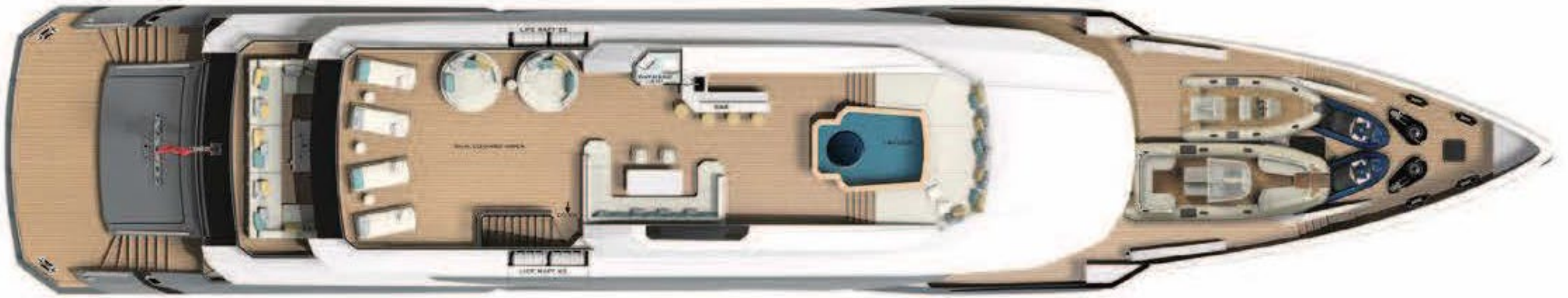

SUNDECK

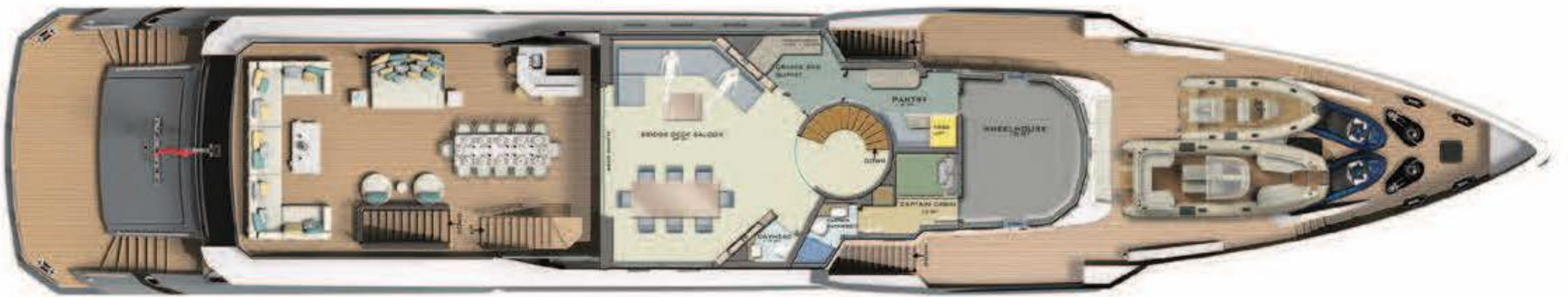

UPPER DECK

> GENERAL ARRANGEMENT

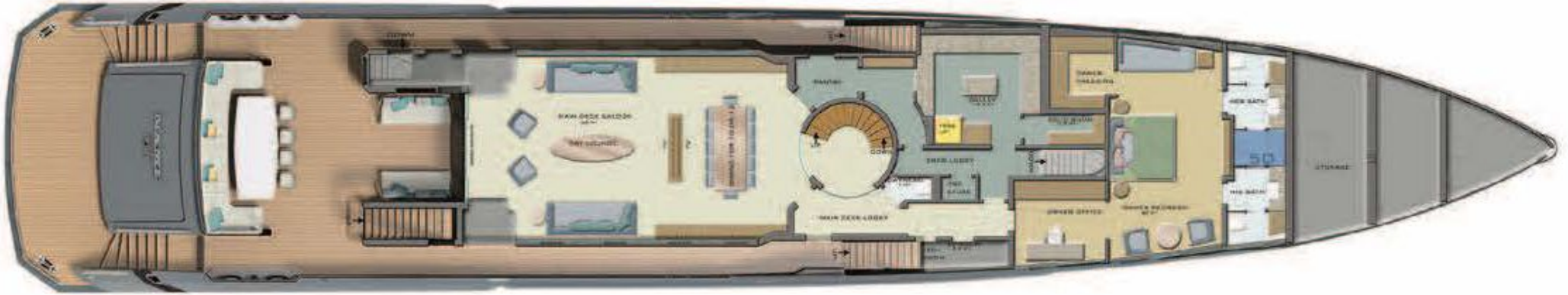

MAIN DECK



LOWER DECK



## › CONTACT INFORMATION

Nord Star Superyachts specializes in yacht sales, construction, management and consulting. We provide a full range of services for yacht owner support: legal assistance, technical survey, shipping, yacht registration, insurance and crew selection.



### **DENIS KHAMZATOV**

Head of Sales

+371 25 630 696

dk@nordstarsuperyachts.com

### **NORD STAR SUPERYACHTS**

Marventas d.o.o.

Tržaška cesta 2,

Ljubljana, 1000 Slovenia

+386 6 818 04 88

info@nordstarsuperyachts.com

www.nordstarsuperyachts.com