



Cantiere Delle Marche Flexplorer 130

40.20 M > 2026 > ITALY

CdM RJ 130

YACHTS FOR SALE

LOA:
40.20 m

YEAR:
2026

ASKING PRICE:
€ 26,300,000
EXCL. VAT

> ABOUT

In order to accommodate diverse Owner preferences and aspirations, the Flexplorer models are adaptable, allowing for maximum flexibility in both configuration and features. This adaptability is the key attribute of the Flexplorer line.

As the name suggests, the Flexplorer has in the flexibility here main train and therefore the aft main deck can be used for different purposes. As a toys' carrier certainly, in fact a tender up to 30' a sailboats and two jet skis can easily be stored. Alternatively, some of the space can be traded to host a submarine. But once the toys are on the water, the deck turns into a sumptuous beach club, including a swimming pool. collapsible bulwarks and stairs at stem that lead directly to the sea. Evening comes and round tables can be laid with candles, soft lights. sweet scents and background music making up for the perfect atmosphere. Hours later, to close-up the day, the deck becomes an open-air dance floor. Arriving to the Flexplorer in style from the sky is also an option, as the main deck is suitable for touch and go helipad operations.

On main deck aft, both side bulwarks can be folded down. thus enlarging the deck space and offering a perfect diving platform. 6 mt in length and covered with teak. when opened the bulwarks sit perfectly flush with the main deck surface.

KEY FEATURES:

- Large spaces
- Delivery in 2026
- Official guarantee
- Italian design

CdM RJ 130

LOA:
40.20 m

YEAR:
2026

ASKING PRICE:
€ 26,300,000
EXCL. VAT

YACHTS FOR SALE

> SPECIFICATIONS

Type	Displacement motor yacht	Deck	Teak
Delivery	2026	Engines	2 x Caterpillar C32 1100 HP
Location	Italy	Max. Speed	14 kn
LOA	40.20 m	Cruising speed	10 kn
Beam	8.60 m	Fuel tank	60 000 l
Draft	2.60 m	Water tank	8 500 l
Displacement	350 t	Range	5 000 nm at 10 kn
GT	420 GT	Guests	10 persons
Naval architecture	Hydro Tec	Crew	7 persons
Interior	Cantiere delle Marche	Guest accommodation	5 cabins: 1 x Double bed MASTER SUIT, 2 x Double bed VIP SUITS, 2 x Twin bedrooms with extra bed
Exterior	Sergio Cutolo-Hydrotec	Crew accommodation	4 cabins: 1 x captain cabin, 3 x twin bed crew cabins
Hull	Steel		
Superstructure	Aluminium		

The company is not responsible for the accuracy of the information provided by the Owner (images, yacht specification, list of installed equipment, its status, engine hours, legal issues). The engine hours are indicated at the time of placing information about the vessel on the site and are periodically updated in the future. Exact parameters and characteristics can be provided at the request of the buyer and are specified in the sales contract. All information provided regarding prices, condition, technical characteristics and / or the possibility of operating yachts on the water is for informational purposes and is not a public offer.









AFT DECK





FOREDECK



SALON



SALON



MASTER CABIN



VIP CABIN

> GENERAL ARRANGEMENT

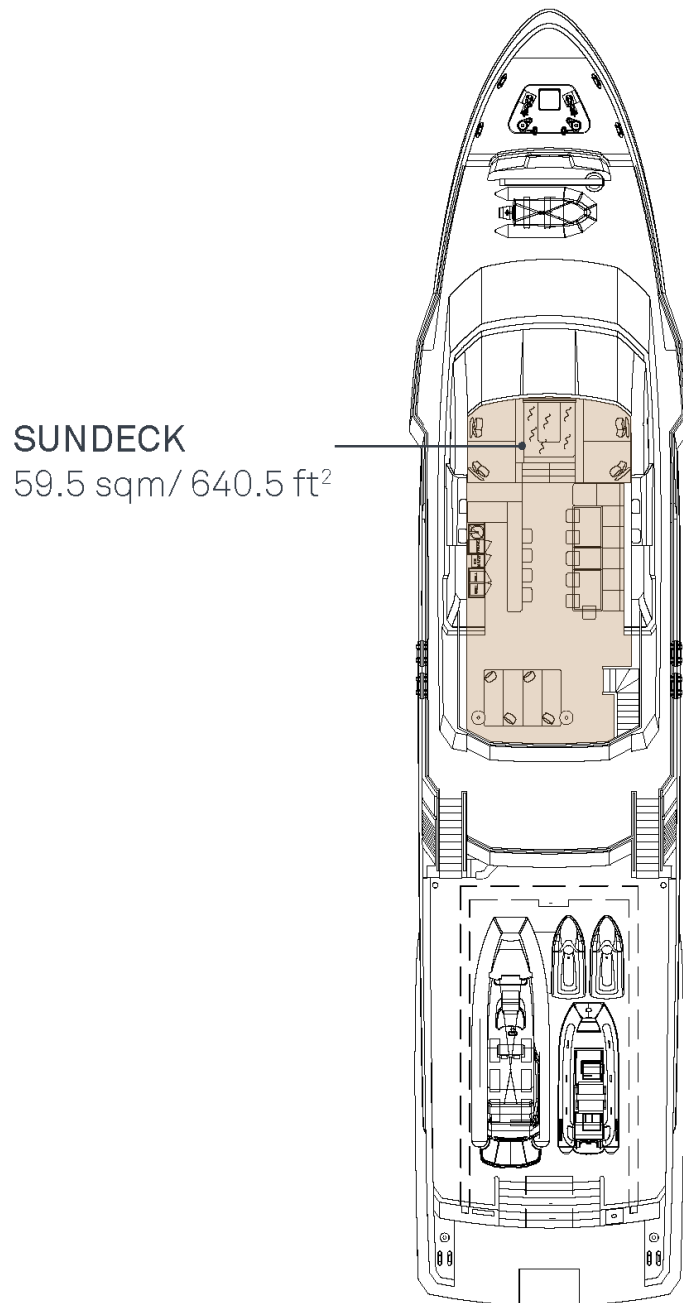

SUNDECK
59.5 sqm/ 640.5 ft²

FOREDECK
26.7 sqm/287.4 ft²

WHEELHOUSE
18.9 sqm/ 203.4 ft²

PANTRY/LOBBY
7.2 sqm/ 77.5 ft²

AFT COCKPIT
38.9 sqm/ 418.7 ft²

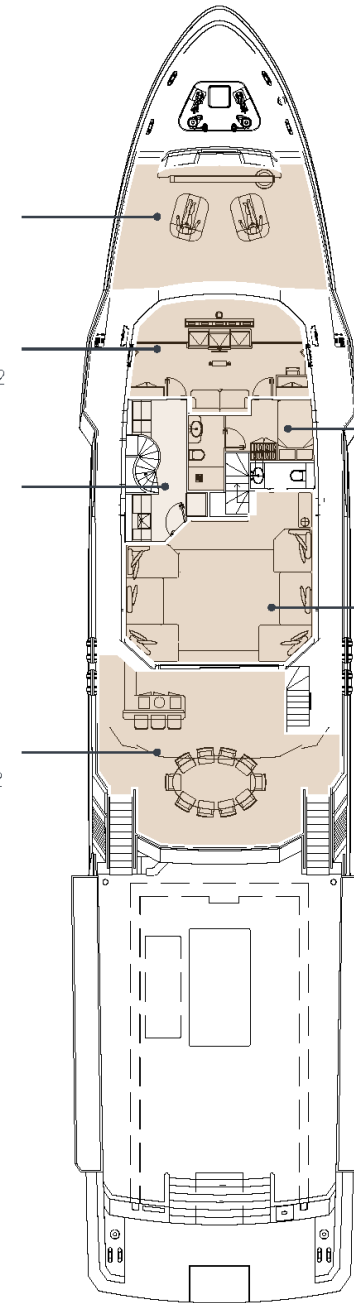

CAPTAIN'S CABIN
8.2 sqm/ 88.3 ft²

SKYLOUNGE
30.2 sqm/325.1 ft²

> GENERAL ARRANGEMENT

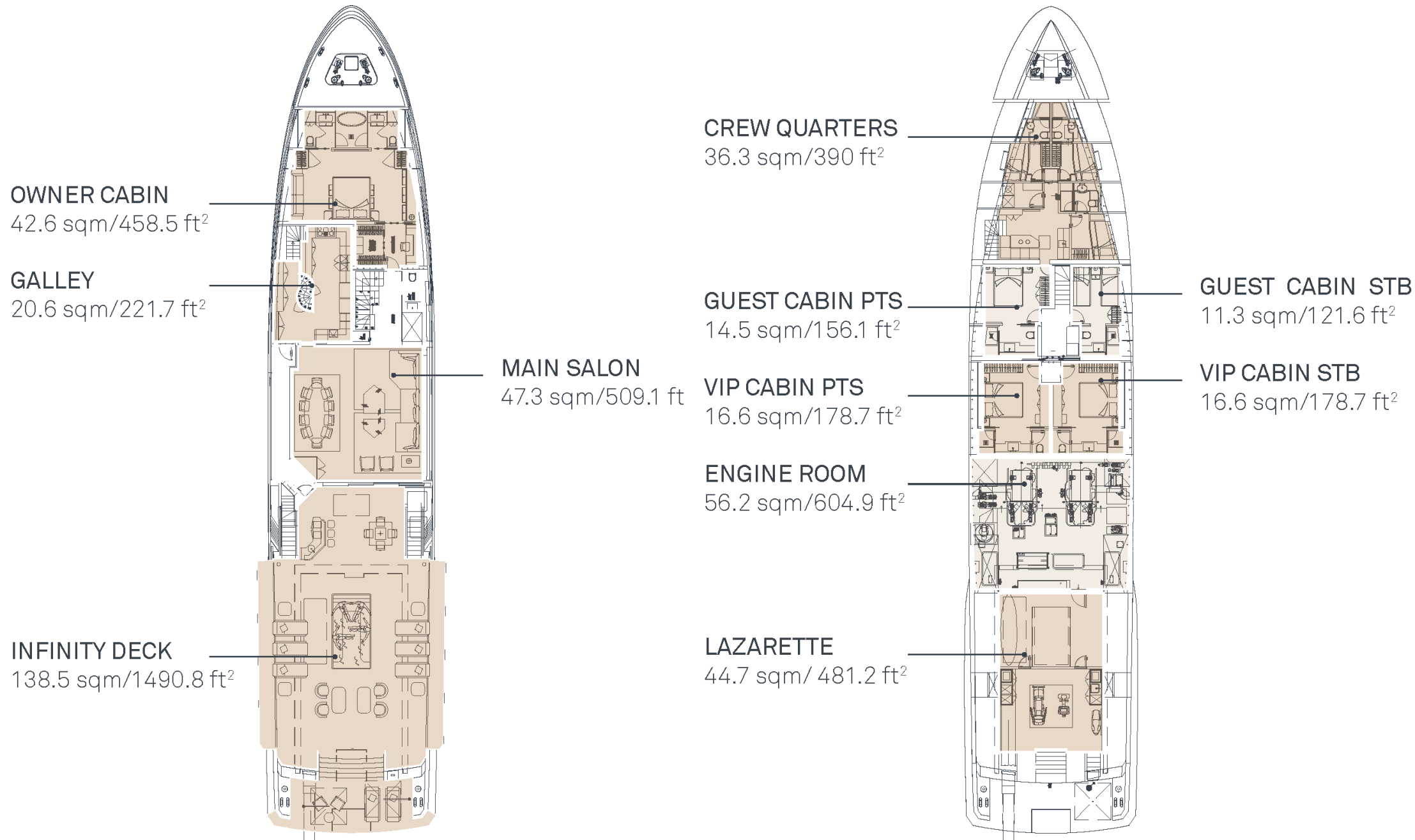



› CONTACT INFORMATION

Nord Star Superyachts specializes in yacht sales, construction, management and consulting. We provide a full range of services for yacht owner support: legal assistance, technical survey, shipping, yacht registration, insurance and crew selection.



DENIS KHAMZATOV

Head of Sales

+371 25 630 696

dk@nordstarsuperyachts.com

NORD STAR SUPERYACHTS

Marventas d.o.o.

Tržaška cesta 2,

Ljubljana, 1000 Slovenia

+386 6 818 04 88

info@nordstarsuperyachts.com

www.nordstarsuperyachts.com